



Items Supplied >

- 1 - Sissy Bar w/ Pad & Interchangeable Chrome Insert
- 2 - Mount Brackets (Left/Right)
- 6 - 3/8-16 x 1 1/4 Buttonhead Bolts
- 6 - Spacers
- 4 - M8 x 20mm Buttonhead Bolts

Application(s) >

HARLEY SOFTAIL DELUXE	
FLSTC	2000 - 2017
FLSTN	2007 - 2017
FLSTS	2000 - 2003

Instruction Manual >

602-1254 / 602-1304

Page 1 of 1

Read all instructions carefully before installing your new Cobra® product!

1. Remove and discard the (3) 3/8 bolts/washers from the right side fender rail. Do NOT loosen left side at this time. Do NOT remove the chrome fender rail.
2. Install right sissybar mounting bracket (part # facing inward) by inserting (3) supplied 3/8-16 x 1 1/4 buttonhead bolts through the sissy bar mount bracket, supplied spacers, chrome fender rail and into the fender nut plates. **DO NOT TIGHTEN AT THIS TIME.**
3. Repeat Steps 1 & 2 on left side.
4. Install the sissy bar between the brackets using the four (4) supplied M8 x 20mm button head bolts.
5. Align sissy bar and tighten all bolts securely.

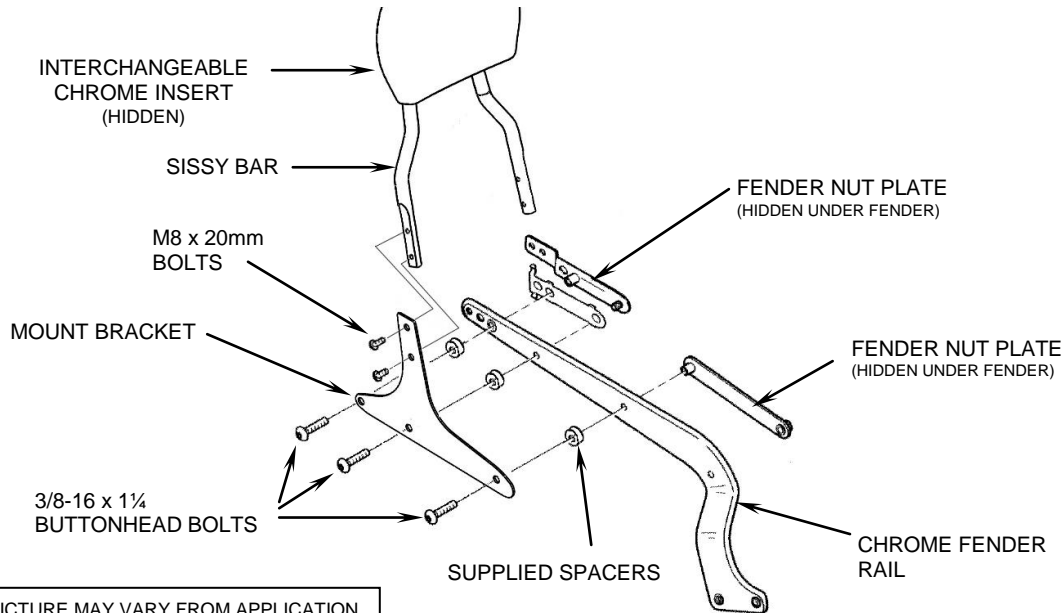

PICTURE MAY VARY FROM APPLICATION

FIGURE 1 (RIGHT SIDE SHOWN)

ALTERNATE BACKREST INSERTS AVAILABLE AT COBRAUSA.COM

* Cobra® recommends you always wear a helmet while riding. Please never operate your motorcycle while under the influence of alcohol and/or drugs. Enjoy the new look of your motorcycle and please ride safely.